



Installation Instructions

REV 1 04/15/20

Part No. **1016**

Product: Running Boards

Application:

Audi Q5 2018+

Level of Difficulty: 1 2 **3** 4 5

Installation Time: 90 min

Hardware	Torque Specifications
M6 Bolt	3 ft-lbs.
M8 Bolt	7 ft-lbs.
M10 Bolt	16 ft-lbs.
M12 Bolt	28 ft-lbs.

ATTENTION: Use correct torque settings to avoid damaging the running boards and or mounting brackets. Failure to do so will void your warranty.

If you have any questions please contact our technical team at 1-866-717-6645

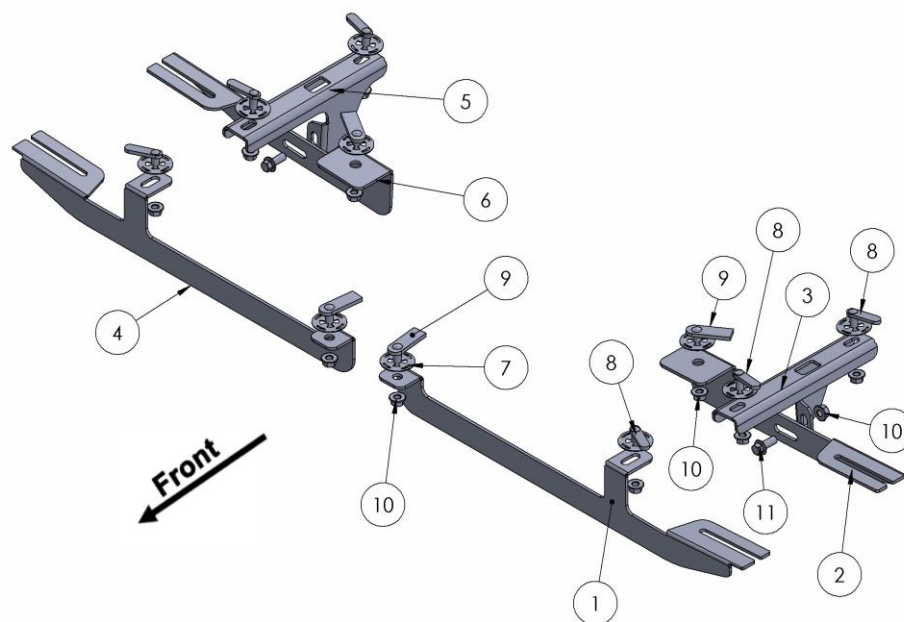

ITEM NO.	PART NUMBER	QTY.
1	1016850F0	1
2	1016850B0	1
3	1016850B1	1
4	Mirror1016850F0	1
5	Mirror1016850B1	1
6	Mirror1016850B0	1
7	HTC 269 - CLIPS (M10)	10
8	HTC 243 - M10x25(4x12x50)	6
9	HTC 230 - M10x25(5x20x60)	4
10	M10 Flange Nut	12
11	M10 x 25 Flange Bolt	2

Installation Instructions 1016 Bracket kit

Video
Installation
Instruction:

NOTE: This vehicle requires undercarriage plastic cover trimming.

Step 1: After removing plastic panels locate front mounting locations and hardware as per 1st page of this installation manual

Step 2: Remove the second rubber plug on the main chassis Figure 1, install provided HTC 230

Step 3: Locate outer mounting point, the rubber plug is directly inline with the inner rubber plug that was just removed. Figure 2 install provided HTC 243 as shown

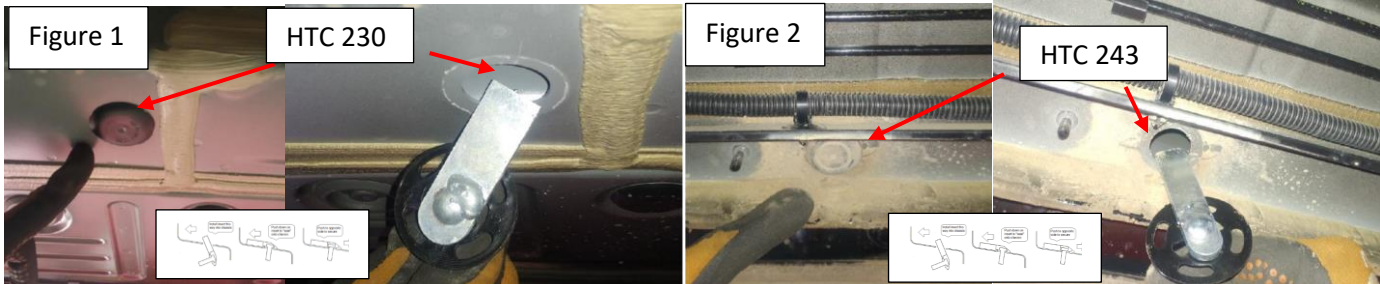

Step 4: Attach main bracket to hardware, Figure 3 do not tighten.



Step 5: Locate rear mounting area and remove factory rubber plugs Figure 4. Install HTC 230 on inner most position and HTC 243 on remaining positions

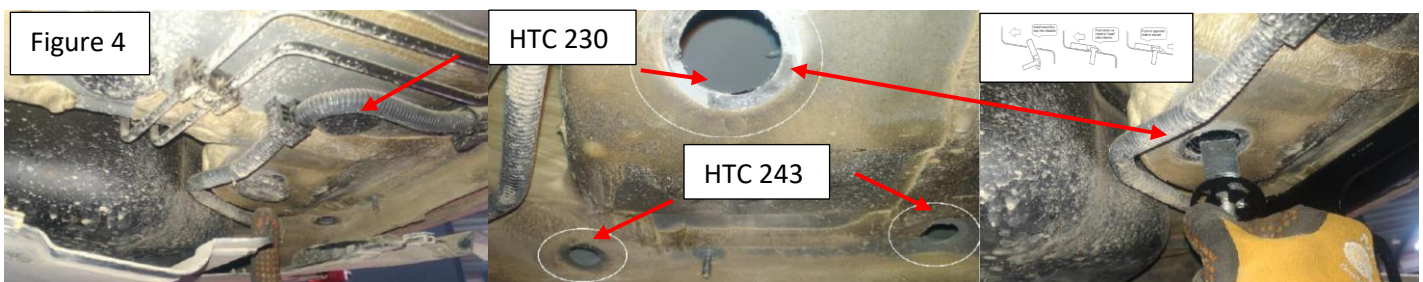

Installation Instructions 1016 Bracket kit

Step 6: Install extra support bracket onto HTC 243 as shown Figure 5

Step 7: Install rear main bracket onto HTC 230 as shown Figure 6, attach two brackets together using supplied M10 hardware.



Step 8: Proceed to last page of this manual for running board install instructions and torque values

Step 9: Raise panels onto vehicle and mark locations to cut.



For Technical support please call our team at 1-866-717-6645 and one of our experts will assist you with this installation

Thank you for choosing Romik.

Running Board Installation Instructions

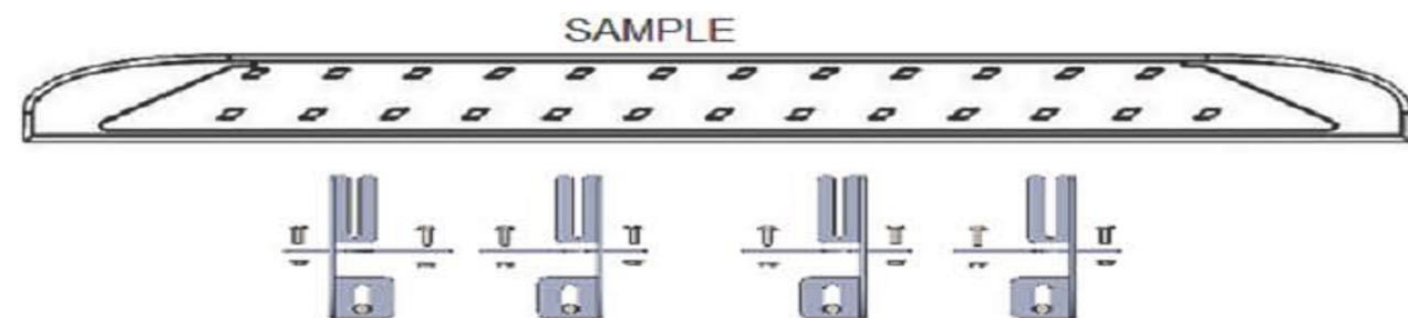

RAL / RB2 / REC / RCV / RZR



ROB / ROF / RPD

- 1) Flip your Romik running boards onto a flat surface, make sure to place the running boards on a towel or cardboard in order to protect the surface Figure 1.
- 2) Loosen the M8 bolts on back of your running boards Figure 2. Depending on your model there will be either 6 or 8 bolts installed per side.
- 3) Once your brackets have been installed, place the running board onto the brackets as shown on Figure 3.
- 4) Adjust running boards, centering on vehicle. Hand tight M8 hardware on running boards.
- 5) Follow the torque procedures, torque M8 hardware to **7 ft-lbs** using a torque wrench.
- 6) Cleaning and maintaining your running boards is important, apply a light coat of a quality carnauba wax at least 2X per year. Wash often with mild soap and make sure to remove all soap residue. Many car automatic carwashes use a strong soap, make sure to use enough water to remove all residue.
- 7) Register your products at www.Romik.com/contact/productregistration
- 8) Warranty information at www.Romik.com/warranty