



## Installation Instructions

REV 2 04/15/20

Part No. **3942**

Product: Running Boards

Application:

**Toyota RAV4 2019+**

Level of Difficulty: 1 **2** 3 4 5

Installation Time: 60 min

Hardware	Torque Specifications
M6 Bolt	3 ft-lbs.
M8 Bolt	7 ft-lbs.
M10 Bolt	16 ft-lbs.
M12 Bolt	28 ft-lbs.

**ATTENTION:** Use correct torque settings to avoid damaging the running boards and or mounting brackets. Failure to do so will void your warranty.

If you have any questions please contact our technical team at 1-866-717-6645

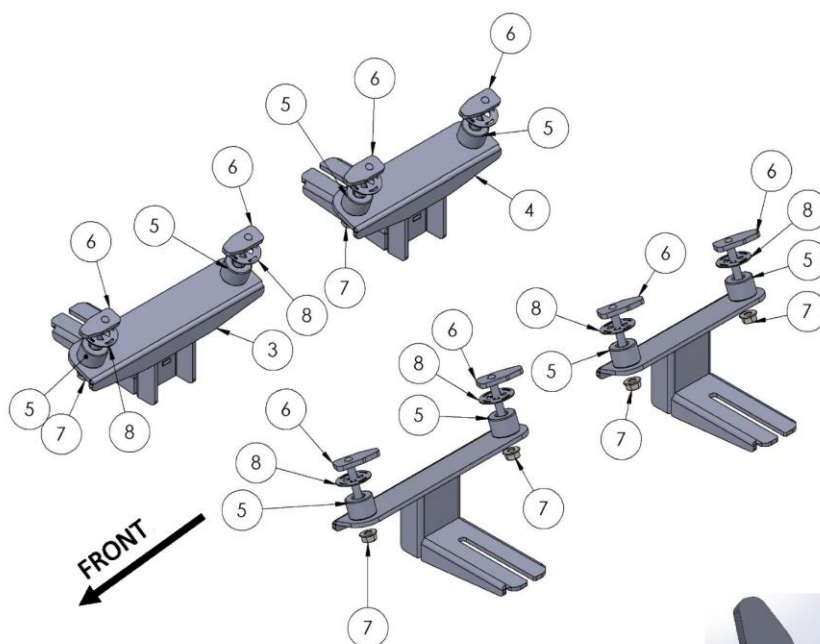

The diagram illustrates two components: a 'Larger Bracket' and a 'Smaller Bracket'. The larger bracket has a width of 200mm, and the smaller bracket has a width of 162mm. Both brackets feature a vertical slot labeled 'FRONT BRACKET' and a horizontal base labeled 'REAR BRACKET'.

ITEM/NO	PART NAME	QTY
1	3942850B DRIVER	1
2	3942850F DRIVER	1
3	3942850F - PASSENGER	1
4	3942850B - PASSENGER	1
5	SPECIAL PIPE 15XØ12Ø25	8
6	HTC 317 - M8x40(5x20x47)	8
7	DIN 6923 Flange Nut M8	8
8	HTC 271 - CLIPS (M8)	8

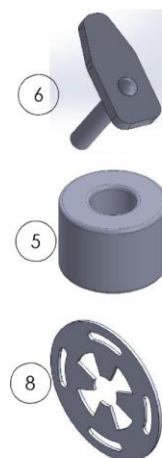

# Installation Instructions 3942 Bracket Kit

Video  
Installation  
Instruction:

**Step 1:** Locate front mounting locations and hardware as per 1<sup>st</sup> page of this installation manual

**Step 2:** Starting from the front of the vehicle remove plug #1 and #2 as shown on Figure 1

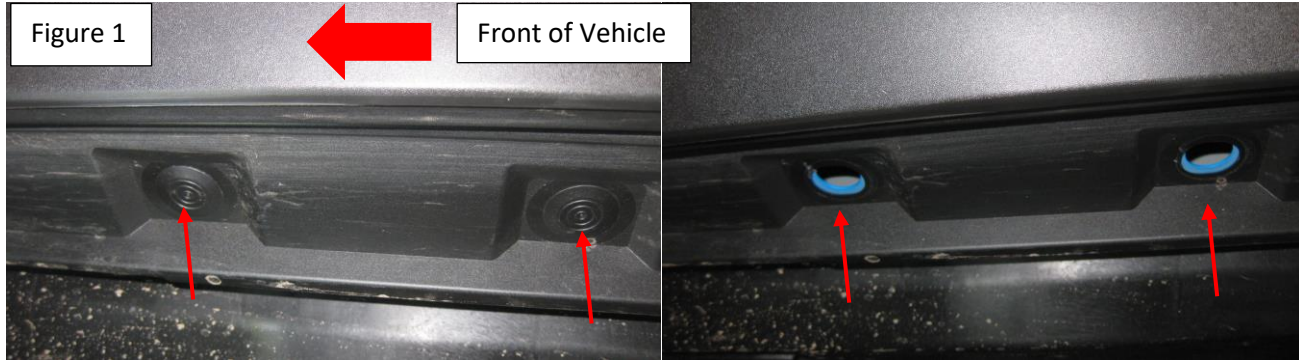

**Step 3:** Install provided HTC 317 as shown Figure 2. Install provided aluminum spacer followed by the front bracket. Do not tighten.

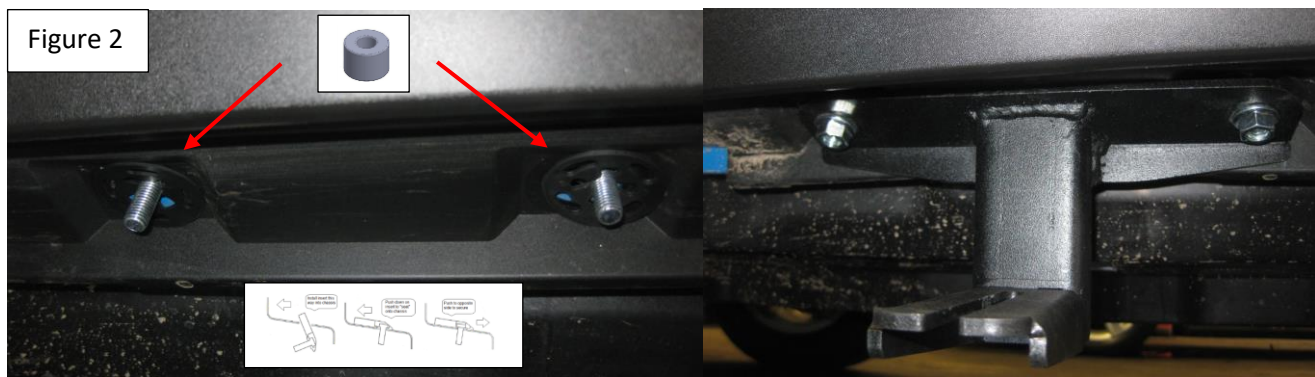

**Step 4:** Remove plug #5 and #6 as shown on Figure 3

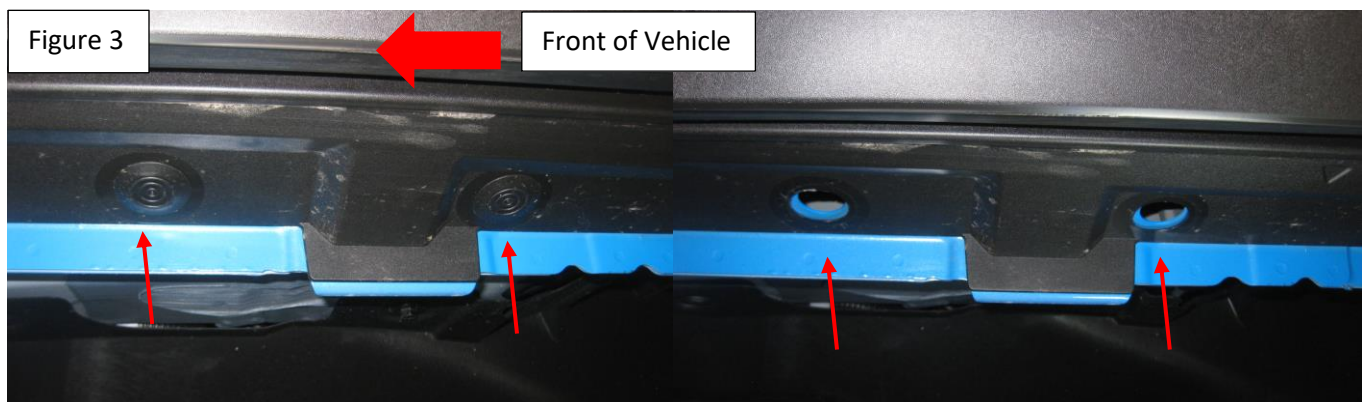

# Installation Instructions 3942 Bracket Kit

**Step 5:** Install provided HTC 317 as shown Figure 4. On some models the aluminum spacer is optional, you will have to see if your model needs it. Install rear bracket. Do not tighten.

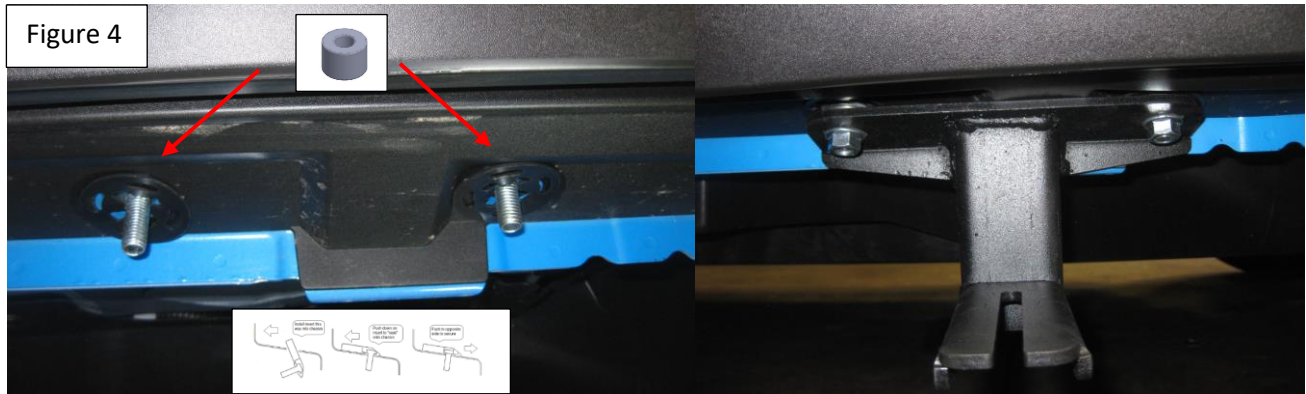

**Step 6:** Proceed to last page of this manual for running board install instructions and torque values

For Technical support please call our team at 1-866-717-6645 and one of our experts will assist you with this installation.

***Thank you for choosing Romik.***

# Running Board Installation Instructions

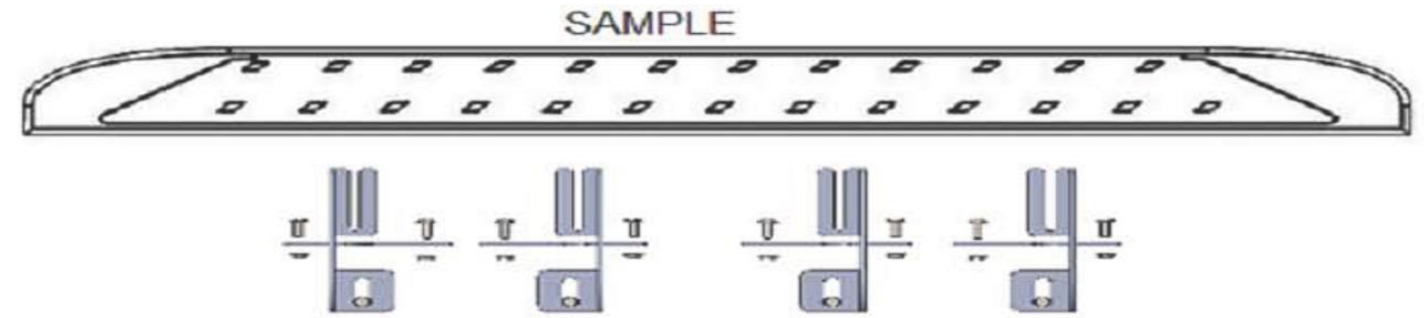

**RAL / RB2 / REC / RCV / RZR**



**ROB / ROF / RPD**

- 1) Flip your Romik running boards onto a flat surface, make sure to place the running boards on a towel or cardboard in order to protect the surface Figure 1.
- 2) Loosen the M8 bolts on back of your running boards Figure 2. Depending on your model there will be either 6 or 8 bolts installed per side.
- 3) Once your brackets have been installed, place the running board onto the brackets as shown on Figure 3.
- 4) Adjust running boards, centering on vehicle. Hand tight M8 hardware on running boards.
- 5) Follow the torque procedures, torque M8 hardware to **7 ft-lbs** using a torque wrench.
- 6) Cleaning and maintaining your running boards is important, apply a light coat of a quality carnauba wax at least 2X per year. Wash often with mild soap and make sure to remove all soap residue. Many car automatic carwashes use a strong soap, make sure to use enough water to remove all residue.
- 7) Register your products at [www.Romik.com/contact/productregistration](http://www.Romik.com/contact/productregistration)
- 8) Warranty information at [www.Romik.com/warranty](http://www.Romik.com/warranty)