



Installation Instructions

REV 3 04/15/20

Part No. **3931**

Product: Running Boards

Application:

Toyota Highlander 2014-2019

Level of Difficulty: 1 **2** 3 4 5

Installation Time: 90 min

Hardware	Torque Specifications
M6 Bolt	3 ft-lbs.
M8 Bolt	7 ft-lbs.
M10 Bolt	16 ft-lbs.
M12 Bolt	28 ft-lbs.

ATTENTION: Use correct torque settings to avoid damaging the running boards and or mounting brackets. Failure to do so will void your warranty.

If you have any questions please contact our technical team at 1-866-717-6645

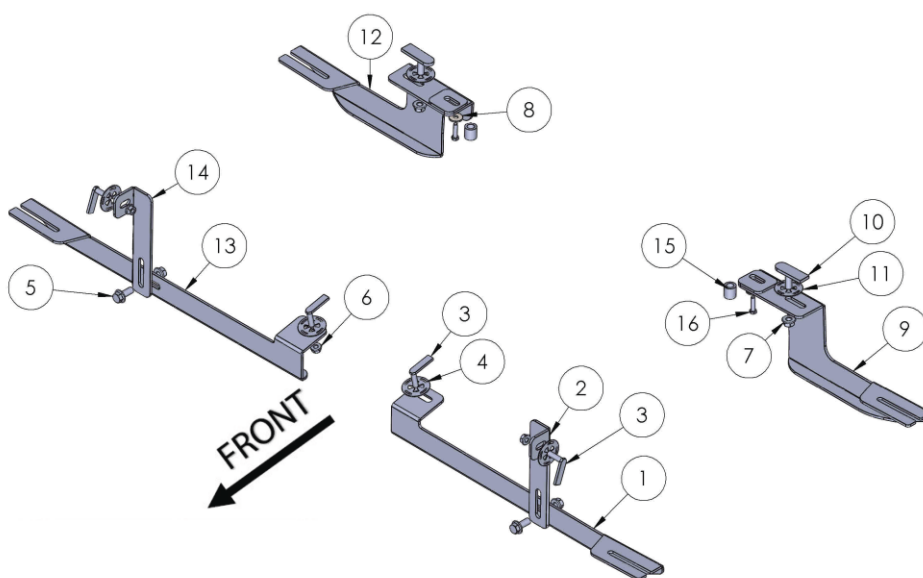

ITEM	PART NAME	QTY
1	3931850F0 DRIVER	1
2	3931850F1 DRIVER	1
3	HTC 226 - M8X30 TIRNAK CÍVATA (4X10X37)	4
4	HTC 271 CLIPS M8	4
5	DIN 6921 FLANGE BOLT - M10 x 25	2
6	DIN 6923 FLANGE NUT - M8	4
7	DIN 6923 FLANGE NUT - M10	4
8	DIN 125 WASHER - M6	2
9	3931850B0 DRIVER	1
10	HTC 238 - M10x30(5x20x60)	2
11	HTC 269 - CLIPS (M10)	2
12	3931850B0 PASSENGER	1
13	3931850F0 PASSENGER	1
14	3931850F1 PASSENGER	1
15	SPECIAL PIPE Ø12 x Ø19 x 20	2
16	DIN 933 BOLT M6x30	2

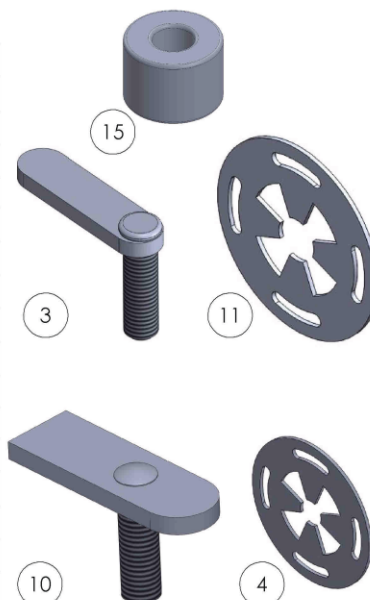

Installation Instructions 3931 Bracket Kit

Video
Installation
Instruction:



NOTE: This vehicle requires undercarriage panel trimming. Slight visible gap due to shape of vehicle body.

Step 1: After removing undercarriage panels locate front mounting locations and hardware as per 1st page of this installation manual. Remove rubber plug Figure 1 and install provided HTC 226 as shown Figure 2



Step 2: Locate extra support area. Remove rubber plug as shown figure 3 and install HTC 226 as shown on Figure 4. Hint when installing HTC rotate so longer part is pointing up use the black plastic washer to put pressure against it so it will not rotate downward. Install extra support while putting pressure on the HTC 226



Step 3: Install main bracket and attach to extra support using supplied M10 hardware Figure 5. Do not tighten



Installation Instructions 3931 Bracket Kit

Step 4: Locate rear bracket mounting area. Remove rubber plug and brake line bolt as shown Figure 6. Install provided HTC 238

Step 5: Install rear bracket as shown Figure 7. Install provided spacer and longer bolt as shown Figure 7. Do not tighten



Step 6: Proceed to last page of this manual for running board install instructions and torque values

Step 7: Cutting the panels and reinstalling them. Red arrow depicts front of vehicle. Remove a 1 ½ inch section on the front driver's side panel. Measure 5 ½ inches from the front and remove approx 15 inches in total.

Measure 19 inches from the passenger side panel and remove 1 ½ inch section as shown below.

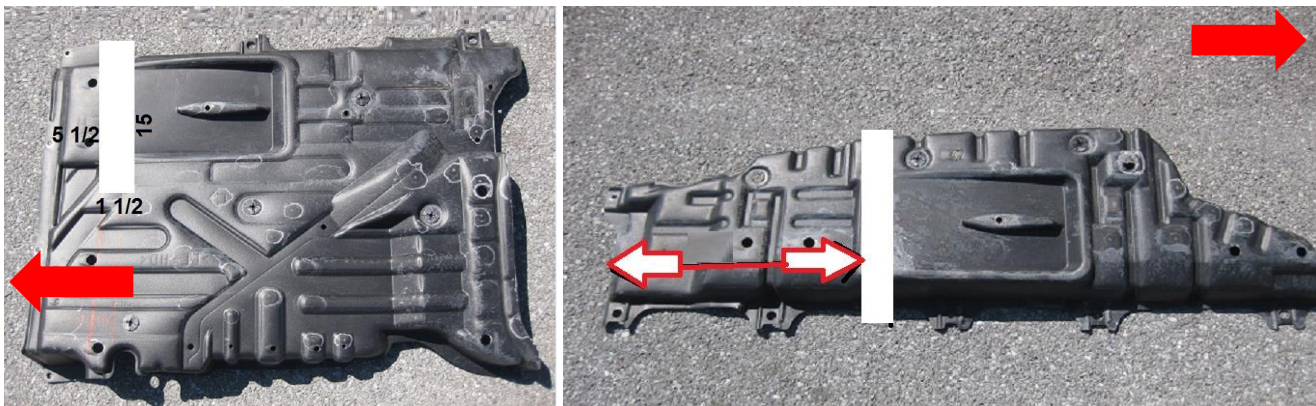

For Technical support please call our team at 1-866-717-6645 and one of our experts will assist you with this installation.

Thank you for choosing Romik.

Running Board Installation Instructions

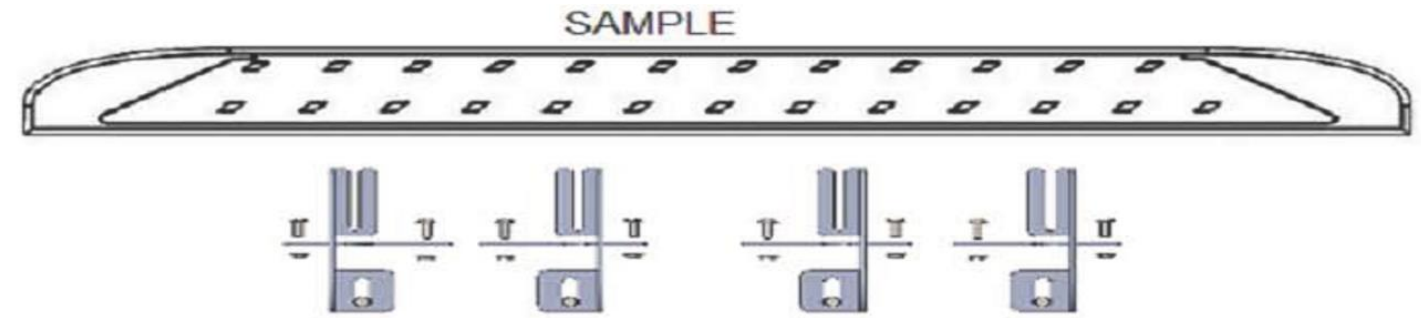

RAL / RB2 / REC / RCV / RZR



ROB / ROF / RPD

- 1) Flip your Romik running boards onto a flat surface, make sure to place the running boards on a towel or cardboard in order to protect the surface Figure 1.
- 2) Loosen the M8 bolts on back of your running boards Figure 2. Depending on your model there will be either 6 or 8 bolts installed per side.
- 3) Once your brackets have been installed, place the running board onto the brackets as shown on Figure 3.
- 4) Adjust running boards, centering on vehicle. Hand tight M8 hardware on running boards.
- 5) Follow the torque procedures, torque M8 hardware to **7 ft-lbs** using a torque wrench.
- 6) Cleaning and maintaining your running boards is important, apply a light coat of a quality carnauba wax at least 2X per year. Wash often with mild soap and make sure to remove all soap residue. Many car automatic carwashes use a strong soap, make sure to use enough water to remove all residue.
- 7) Register your products at www.Romik.com/contact/productregistration
- 8) Warranty information at www.Romik.com/warranty